

[LEGAL NOTICE NO. 37]

LAND USE DECREE 2010
(DECREE NO. 36 OF 2010)

DESIGNATION
(NO. 4 OF 2013)

BY Commodore Josaia Voreqe Bainimarama, CF (Mil), OSTJ, MSD, jssc, psc, Prime Minister of the Republic of Fiji and Commander of the Fiji Military Forces.

IN EXERCISE of the powers conferred upon me by subsection 2 of section 6 of Part 2 of the Land Use Decree 2010, I do hereby designate the portion of Native Land with boundaries shown in orange on Land Use Unit Plan (LU) 085 being part of Lot 135 NLC 54 A owned by the Mataqali Navorara on Sheet M 3/2 with an area of approximately 15 acres with copies in the custody of Director Land Use, Ministry of Lands and Mineral Resources for utilization under the Land Use Decree 2010.

Given under my hand at Suva the 2nd day of June 2013.

J. V. BAINIMARAMA
Prime Minister of the Republic of Fiji

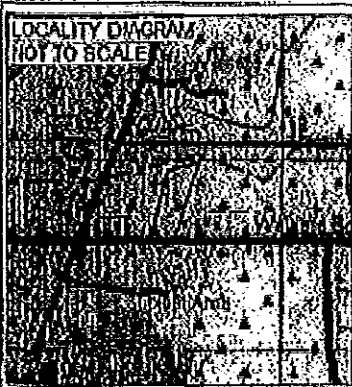

213
NLC 293
MATAQALI NAKALIDAMU

94
NLC 47
MATAQALI VUTUVO

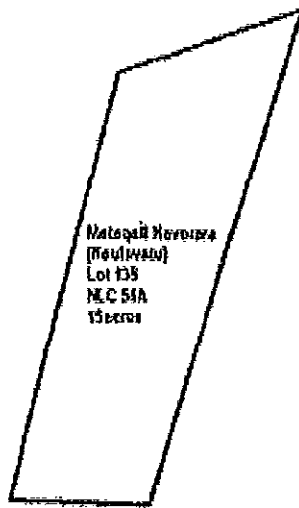

134
NLC 526
MATAQALI VALEMAGO

<p>REFERENCE</p> <p>SHEET REF : M 3/2 SCALE : 1 : 1500(approx)</p> <hr/> <p>FILE REF : LU 3/55</p>	<p>PLAN SHOWING</p> <p>DESIGNATED AREA-LAND USE DEGREE 36/2010</p> <p>LEGAL DESCRIPTION LOT 135 NLC 54A</p> <p>MATAQALI NAVORARA</p> <p>AREA : 15 acres (approx)</p> <p>TIKIHA OF NAKELO</p> <p>PROVINCE OF TALEVU ISLAND OF VITI LEVU</p>	<p>DESIGNATED PLAN</p> <p><u>LU 085</u></p>
---	---	--